

**INDIAN INSTITUTE OF ASTROPHYSICS  
2<sup>ND</sup> BLOCK, KORAMANGALA,  
BENGALURU – 560034.**

## **TENDER DOCUMENT**

*Name of Work: Renovation of Guest rooms and General toilets with a provision of toilet for Divyangjan at Main Lab building CREST campus, I.I.A, Hosakote, Bengaluru Rural Dist.*

**Tender Notice No.: 56/IIA/CIVIL/CREST/HOSAKOTE/2022-23 Dated 04.07.2022**

**INDIAN INSTITUTE OF ASTROPHYSICS**

**Ph.**080-2554 1200/1259/1359 , **Fax:** 25534043

**Website:** [www.iiap.res.in](http://www.iiap.res.in)



**INDIAN INSTITUTE OF ASTROPHYSICS**

**2<sup>ND</sup> BLOCK, KORAMANGALA,**

**BENGALURU-560 034.**

**Tender Notice No.: 56/IIA/CIVIL/CREST/HOSAKOTE/2022-23 Dated 04.07.2022**

**SINGLE STAGE -TWO COVER SYSTEM**

The Director, Indian Institute of Astrophysics invites sealed item rate tenders in the prescribed format for the following work from appropriate registered class I contractors in state PWD/CPWD and who have executed works of similar nature with central or state Govt. / Autonomous institutions / Research institutions / Govt. undertakings.

Sl. No.	Name of the work	Estimated cost in Rs.	Time for completion	EMD	Cost of tender document Rs.
1.	<b>Renovation of Guest rooms and General toilets with a provision of toilet for Divyangjan at Main Lab building CREST campus, I.I.A, Hosakote, Bengaluru Rural Dist.</b>	41,23,000/-	06 Months	82,500/-	1,000/-

The Tender Document can be viewed and downloaded from our website [www.iiap.res.in/tenders.htm](http://www.iiap.res.in/tenders.htm). The interested tenderers may at their option download the same, as **“NO” hard copies of Tender document shall be provided from this office** and submit their offers along with Tender fee (non-refundable) prescribed therein, only in the form of Demand Draft drawn in favor of **“Indian Institute of Astrophysics”** payable at Bangalore. The DD shall be valid for a period of ninety days (90) from the date of opening of bids.

The Offers containing complete tender document (Published in IIA website) duly filled and signed with all necessary particulars complete credentials including experience/completion certificates, tender document fee, EMD etc. should be submitted in sealed cover (COVER -1) and priced Bill of Quantities in sealed Cover (Cover -2). Both Cover 1 & 2 shall be put in Cover -3 super scribing the envelope with **“Renovation of Guest rooms and General toilets with a provision of toilet for Divyangjan at Main Lab building CREST campus, I.I.A, Hosakote, Bengaluru Rural Dist.”**. Notice No. and due date”, shall be submitted addressed to **The Director, Indian Institute of Astrophysics, 2<sup>nd</sup> Block, Koramangala, Bengaluru – 560 034. The last date of submission of bid is 05.08.2022 on or before 15:00 hrs.**

Only **TECHNICAL BIDS (COVER 1)** will be opened at **15:30 hrs on the same day** in the presence of attending tenderers or their authorized representatives.

**Financial bids (Cover 2)** of technically qualified bidders will be opened with prior intimation.

**COVER 3-** Containing Cover 1 & 2 will be sealed in Cover 3

**SITE VISIT:**

All intended bidder's may **visit the site at 11:00 AM on 18.07.2022** and get all necessary clarifications regarding tender document, site, availability of materials, labors, etc., from the Civil Engineering Section.

**ELIGIBILITY CRITERIA**

The firms who fulfill the following requirements shall be eligible to submit their bids. Joint ventures are not acceptable.

- (i) Tendering Company shall be professionally managed and resourceful for taking up similar jobs.
- (ii) The experience of having successfully completed similar work during last 5 years as on 30.06.2022 should be either of the following:

- a) One similar completed work costing not less than the amount equal to 80% of the estimated cost.

OR

- b) Two similar completed works costing not less than the amount equal to 50% of the estimated cost.

OR

- c) Three similar completed works costing not less than the amount equal to 40% of the estimated cost.

**Similar work shall mean:**

**Similar work experience shall mean that the bidder shall have an experience in new building construction or renovation works at office building in central / state Govt. or research institutions, which includes Renovation of toilets, plumbing, sanitary & minor civil works, waterproofing work, painting work, repairing of doors and windows, changing of floor and wall tiles, construction of Divyangjan toilet etc. In support of this, the bidder must submit completion Certificate / work orders from the Client indicting the nature of work executed, and the same shall be included in the Bid as Supporting Documents.**

**Documentary Proof for Eligibility**

Self attested/certified copy of work orders and completion certificates issued by the authority concerned to establish work experience shall be attached to the tender document. Photographs of such works shall be attached for reference. Copies of the Income Tax Returns along with Financial Statements such Balance Sheet, Assessment report issued by Income Tax dept, P&L Account etc for the last 3 Financial Years shall be attached to the tender document.

Valid class I Contract License issued by the competent authority in state PWD / CPWD shall be enclosed.

## **OTHER CONDITIONS**

1. Technical (Cover 1) & price Bids (Cover 2) supported by the above information should be submitted in a Sealed envelope (Cover 3) duly super scribed with the name of work, tender notice No., Last date of submission. The completed Bids will be received by this office **up to 15:00 Hrs. on 05.08.2022.**
2. If any information furnished by the tenderers is found incorrect at a later stage, the firm shall be liable to be debarred from tendering and taking up of work in I.I.A. The Institute reserves the right to verify the particulars furnished by the tenderers.
3. The firms should submit their offers along with Tender fee of prescribed amount up to **15:00 Hrs. on 05.08.2022.**
4. Incomplete Technical Bids are liable for rejection.
5. Late & / delayed offer will not be considered.
6. IIA is not responsible for any delay / loss of documents in transit.
7. The Tenders will be opened **on 05.08.2022 at 15:30** hours at **I.I.A, Bengaluru** in the presence of bidders or their authorized representatives. The representatives of the tenderers should bring authorization letter / identification while attending for opening of the tenders.
8. IIA reserves the right to reject any or all tenders without assigning any reasons.
9. **The lowest quoted bidder cannot claim as lowest bidder unless the bidder satisfies all the tender conditions, technical qualifications and eligibility with supported documents complete in all respect. IIA may inspect the completed projects which are mentioned in the bid before finalizing the award of work.**

Administrative Officer  
IIA, Bengaluru -34.

**INDIAN INSTITUTE OF ASTROPHYSICS**  
2<sup>nd</sup> Block, Koramangala, Bengaluru - 560 034.

**Tender Notice No.: 56/IIA/CIVIL/CREST/HOSAKOTE/2022-23 Dated 04.07.2022**

M/s.

Dear Sir,

The Director, Indian Institute of Astrophysics, Bengaluru invites Sealed Tenders for the work of **“Renovation of Guest rooms and General toilets with a provision of toilet for Divyangjan at Main Lab building CREST campus, I.I.A, Hosakote, Bengaluru Rural Dist.”**. The Tender Terms enclosed herewith may be noted carefully. If you are in a position to quote for the work in accordance with the requirement, please submit your quotation in the attached Tender Form.

Your Tender must reach this office on or before the date and time indicated in the Tender Schedule.

Thanking you,

Yours faithfully,

Encl: as above.

Administrative Officer

For Director

### 3. INSTRUCTIONS TO THE TENDERERS

1. The tenderers should submit the entire tender document with duly filled with price and technical details of the firm. All the pages of document shall be duly signed.
2. **The rates quoted by the tenderer in the schedule shall be inclusive of all taxes and levies. Such rates should provide the break-up of the cost and applicable taxes, levies etc.**
3. The Offers should be submitted in sealed envelope super scribed with Tender for **“Renovation of Guest rooms and General toilets with a provision of toilet for Divyangjan at Main Lab building CREST campus, I.I.A, Hosakote, Bengaluru Rural Dist.”**. Notice No. and due date”.
4. If any clarification is required should be obtained before filling Tender Document.
5. If any discrepancy is there between figures and words for quoted rates, the lower of the two will be considered for the purpose of evaluation.
6. The tenderers who do not fulfill all or any of the tender conditions or if the tender is Incomplete in any respect, will be summarily rejected.
7. The Institute is not bound to accept the lowest tender.
8. Even though the Tenderers meet the above criteria, they are subject to be disqualified if they have (The Institute reserves the right to verify the particulars furnished by the tenderers.)
  - Made misleading or false representations in the forms, statements and attachments submitted in proof of the qualification requirement, Conditional bid / proposal: and / or
  - Record of poor performance such as abandoning the works, not properly completing the contract, inordinate delays in completion, litigation history, or financial failures etc.
9. Any effort by the contractor to influence the client in the bid evaluation, bid comparison or contract award decision results in rejection of the contractors bid.
10. Financial offer will be considered if the bidders fulfill all the technical and financial eligibility criteria as per tender.
11. Late & / delayed offer will not be considered at all.
12. IIA is not responsible for any delay / loss of documents in transit.
13. No bids will be considered if prescribed Tender Fee and bid security declaration form are not found with the bid.
14. All overwriting and corrections shall be duly attested with stamp & signature.
15. Corrigendum's / modifications / corrections, if any, will be published in the website only.

16. The Director, Indian Institute of Astrophysics reserves the right to accept or reject the tenders in full or part without assigning any reason thereof.
17. Performance certificates of the completed works issued by the clients to be enclosed in the technical bid.
18. The committee constituted by the Director may inspect the previously completed or the ongoing works of the bidders to assess their technical suitability for the tendered work.
19. All the pages of the tender document to be signed by the contractor and submit them in the respective sealed covers.
20. The successful contractor will have to execute an Agreement with the Institute within 21 days of receipt of Letter of Intent / Work Order.
21. The lowest quoted bidder cannot claim as lowest bidder unless the bidder satisfies all the tender conditions, technical qualifications and eligibility with supported documents complete in all respect.
- 22. All the bidders are requested to visit the site before quoting the rates. The complete document shall be read and understood in all respect. If any clarification is required, the same may got cleared before submitting their offers in writing by contacting the following persons:**

**M.V.Ramaswamy**  
**Head, Civil Engineering Section**  
**Ph. No. 080-2254 1207**  
**Mobile: 9742410480**  
**E-mail.: [mramaswamy@iiap.res.in](mailto:mramaswamy@iiap.res.in)**

23. All the bidders are requested to visit Institute website [www.iiap.res.in/tenders.htm](http://www.iiap.res.in/tenders.htm) till last date of submission of bids for latest updates on addendum, corrigendum, extensions etc. which will be notified only in website. No individual information will be provided.

\*\*\*\*\*

**INDIAN INSTITUTE OF ASTROPHYSICS**

**2<sup>ND</sup> BLOCK, KORAMANGALA,**

**BENGALURU – 560 034.**

*Name of Work:* **“Renovation of Guest rooms and General toilets with a provision of toilet for Divyangjan at Main Lab building CREST campus, I.I.A, Hosakote, Bengaluru Rural Dist.”**

**Tender Notice No.: 56/IIA/CIVIL/CREST/HOSAKOTE/2022-23 Dated 04.07.2022**

Name of

The Firm: \_\_\_\_\_

Address: \_\_\_\_\_

\_\_\_\_\_

\_\_\_\_\_

Phone No: \_\_\_\_\_

**Last date for submission: 05.08.2022 up to 15:00 hrs**



**FORMAT FOR SUBMISSION OF TECHNICAL & ORGANIZATIONAL DETAILS.**

**NAME OF THE FIRM :**

**1. OFFICE SET UP OF THE FIRM**

1.1 Office Address:

.....  
.....

1.2 Year of Establishment:

1.3 Contact Person Shri .....

With Designation .....

Ph No.....

Fax No.....

E-mail.....

1.4 Details of registration if any: .....

.....

1.5 Organizational setup of the firm

Total staff strength both technical

And Administration with their name, age

Qualification and experience : .....

1.6 PAN (photocopy to be enclosed) .....

GSTIN No (photocopy to be enclosed) .....

1.7 Details of the staff as per the following format.

<b>Sl. No</b>	<b>Profession/ discipline</b>	<b>Name</b>	<b>Age</b>	<b>Qualification</b>	<b>Experience (total years)</b>	<b>Field of experience</b>
	<b>Civil</b>					

## **2 TENDERER'S EXPERIENCE**

Details of Works carried out and on hand during last five years with details such as name of work, year of completion, client name and address, cost of work, time period of construction, nature of work, etc., (It shall enclose a certificate from the owner that the service rendered by the firm has been satisfactory)

<b>Sl. No.</b>	<b>Name &amp; description of work</b>	<b>Value of work and date.</b>	<b>Period of construction and date.</b>	<b>Client persons to whom reference may be made.</b>

### **3. TOOLS AND EQUIPMENT LIST**

The tenderer shall indicate herein below the equipment he has in possession and the equipment he proposes to bring to the site, in case the work is awarded to him.

<b>Sl. No</b>	<b>Type and Description of the equipment.</b>	<b>Numbers the bidder has in possession</b>	<b>Numbers he proposes to bring on to site</b>

Tenderers hereby confirms that the quantity and type of tools he will employ for construction will not be less than those listed above and agree to bring more equipment if so warranted in the opinion of the Engineer-in-charge.

**4. FINANCIAL**

Bank Name: \_\_\_\_\_

Branch: \_\_\_\_\_

Account No.: \_\_\_\_\_

Average Annual Turnover for last 5 Years: \_\_\_\_\_

**5. INSURANCE**

Accident Insurance

Insured with: \_\_\_\_\_

Policy No.: \_\_\_\_\_

6. Details of Arbitration cases : .....

7. Any other detail you would like to intimate in support of your technical bid for appointment : .....

Signature of the authorized  
Person with seal of the firm

(Note: Attach separate sheet for furnishing information in case the space in the format is insufficient)

**INDIAN INSTITUTE OF ASTROPHYSICS  
2<sup>ND</sup> BLOCK, KORAMANGALA,  
BENGALURU – 560034.**

**PRICE BID**

***Name of Work:* “Renovation of Guest rooms and General toilets with a provision of toilet for Divyangjan at Main Lab building CREST campus, I.I.A, Hosakote, Bengaluru Rural Dist.”**

**Tender Notice No.: 56/IIA/CIVIL/CREST/HOSAKOTE/2022-23 Dated 04.07.2022**

Name of

The Firm:

\_\_\_\_\_

Address:

\_\_\_\_\_

\_\_\_\_\_

\_\_\_\_\_

Phone No:

\_\_\_\_\_

**Last date for submission: 05.08.2022 at 15:00 hrs**

**Tender for the “Renovation of Guest rooms and General toilets with a provision of toilet for Divyangjan at Main Lab building CREST campus, I.I.A, Hosakote, Bengaluru Rural Dist.”**

**Conditions of contract**

Sealed item rate tenders are invited by Indian institute of Astrophysics for the above mentioned work

Estimated cost : **Rs. 41,23,000.00 (Rupees Forty one Lakhs Twenty three thousand only)**

Time of completion : **Six (06) Months.**

Period of commencement : 7 days from the date of receipt of work order

Retention money/Security Deposit : 5% to be deducted from each RA bill and final bill, shall be released after one year of completion of work, deducting the cost if any towards the cost of defects rectified by employer due to lack of response of the contractor on completion of defects liability period and on certification by the engineer –in charge.

Defects liability period : 12 Months.

Amount of liquidated damage : Liquidated Damages will be deducted from the bill amount while making final payment for delay in completion of work if any, as per the extant rules of the CPWD.

Escalation : In view of the short duration of the contract, no escalation will be paid to the contractor on account of changes in the market prices of any items of work or changes in the cost of living indices etc.

Tax deduction at source : Statutory taxes will be deducted while making payment from time to time as applicable.



The Director, Indian institute of Astrophysics reserves the right to reject any or all the tenders without assigning any reason whatsoever.

The tenderer shall be responsible for arranging and maintaining at his own cost all **materials, tools and plants, water, electricity**, facilities **for workers, safety norms** and all other services required for executing the work.

Timely completion of work and quality of workmanship are of prime importance and the work shall be completed within the stipulated period. Cement consumption must match with standard theoretical calculations. Recovery to be effected in the event of not fulfilling the cement consumption. The waterproofing is the main work for which five year performance guarantee need to be provided by the applicator.

I/ We have read the tender notice, specifications, schedule, drawings, general rules and all other contents of the tender conditions, and Understand that you are not bound to accept the lowest or any tender you may receive.

I/ we hereby tender for the execution for the work specified above within the time specified above, at the rates specified in the attached bill of quantities and in all respects with these specifications, design, drawings and instructions.

I/we agree that should I/we fail to commence the work specified in the above memorandum an amount equal to amount of earnest money mentioned in the form of invitation of tender shall be absolutely forfeited to the Director.

**Dated: -----**

**Signature of the contractor with stamp**

## **General conditions of contract.**

### **Item rate tender for works.**

- The institute reserves the right to alter the scope /or reduce quantum of work before issue of work order and the contractor shall not have any claim what so ever on this account.
  
- Rates quoted by the contractor in item rate tender in figures and words shall be accurately filled in so that there is no discrepancy in the rates written in figures and words. However if a discrepancy is found, the rates which correspond with the words worked out by the contractor shall be taken as correct.
  
- If the amount of an item is not worked out properly by the contractor or it does not correspond with the rate written either in figures or words, then the rate quoted by the contractor in the words shall be taken as correct.
  
- When the **rates quoted by the contractor in figures and in words** tally but the amount is not worked out correctly the rate quoted in words by the contractor will be taken as correct and not the amount.
  
- The contractor shall take all precautionary measures to prevent entry of dust, dirt and noise pollution to the adjacent buildings and keep the premises neat and tidy, remove surplus materials and rubbish and shall not cause inconvenience to the staff of IIA. If the contractor or his working people or servants shall break, deface, injure or destroy any part of a building in which they may be working or any buildings, road, kerbs, fence, enclosure, water pipes cables, drains, electric and telephone posts or wire, trees grass or garden. The cost of any such damage and risks arising out of this shall be entirely borne by the contractor.
  
- A bill shall be submitted by the contractor each month on or before the date fixed by the Engineer- in charge. All the measurements of the work may be recorded jointly by the Engineer-in charge and the contractor or their respective representatives. The measurements will be taken at site, as per latest IS code of practice for measurements. All measurements shall be taken with steel tapes only.
  
- The Engineer- in -Charge shall have full powers to the removal from the premises of all materials and bad workmanship, which in his opinion are not in accordance with the specifications.

- The Engineer –in- Charge may require the contractor to dismiss or remove from the site of the work any person or persons in the contractors employ upon the work who may be in competent or misconduct himself.
  
- For working on Sundays, holidays and late hours prior permission will be accorded by the Engineer-in charge on the application made by the contractor.
  
- All works to be executed under the contract shall be executed under the direction and subject to the approval in all respects of the Engineer-in charge who shall be entitled to direct at what point or points and in what manner they are to be commenced and from time to time carried on.
  
- The contractor shall treat all materials obtained during dismantling of a structure, excavation of the site for a work etc as institute’s property and such materials shall be disposed off to the best advantage of the institute.
  
- The contractor shall execute the whole and every part of the work in the most substantial and workman like manner and in strict accordance with the specifications of the CPWD / DOS / Bureau of Indian Standards. In case of any class of work for which there is no such specifications the contractor shall carry out the work in all respects in accordance with the instructions in writing of the Engineer- in charge.
  
- The Engineer-in charge shall have powers to make any alterations in, omissions from, additions to or substitutions for the original specifications, drawings, designs and instructions that may appear to him necessary or advisable during the progress of the work and the contractor shall carry out the work in accordance. The rates for such additional, altered or substituted items of work shall be worked out in accordance with the standard procedure followed in CPWD / DOS.
  
- If at any time after the commencement of the work, the Director shall for any reason whatsoever not require the whole thereof as specified in the tender to be carried out, the Engineer- in-Charge shall give notice in writing of the fact to the contractor who shall have no claim to payment of compensation whatsoever on account of any profit or advantage which he might have derived from the execution of the work in full, but which he did not derive in consequence of the full amount of the work not having been carried out, neither shall he have any claim for compensation by reason of any alterations having been made in the original specifications , drawings ,designs and instructions which shall involve any curtailment of the work as originally contemplated.

- ❑ The contractor shall obtain a valid license under the Contract Labour (R&A) act 1970 and the contract labour (Regulation & Abolition) central rules, 1971 before the commencement of the work and continue to have a valid license until the completion of the work. No labour below the age of eighteen years shall be employed on the work. The contractor shall pay to labour employed by him either directly or through sub contractors, wages not less than fair wages as defined in the provision of the contract labour (R&A) act 1970 and the contract labour (R&A) central rules 1971 wherever applicable.
  
- ❑ The contractor shall at his own expenses arrange for the safety provision as per safety code framed from time to time and shall at his own expenses provide for all facilities in connection therewith.
  
- ❑ The contractor shall comply with all the provisions of the payment of wages act 1936, Minimum Wages Act 1948, Employees liability act 1938, Workmen's Compensation act 1923, Industrial Disputes Act 1961 and the Contractors Labour (R&A) Act 1970 or the modifications thereof or any other laws relating thereto and the rules made there under from time to time. The regulations aforesaid shall be deemed to be a part of this contract and any breach thereof shall be deemed to be a breach of this contract. Security deposit will not be refunded till clearance certificate from Labour Officer is obtained by contractor.
  
- ❑ The contractor shall make his /their own arrangements for water required for the works and nothing extra will be paid for the same, as the water available from the institute source may not be sufficient to meet the construction.
  
- ❑ The contractor shall have all the tools and plants necessary to carry out the work such as concrete mixer, vibrator and hoist. The contractor shall employ one graduate engineer during the execution of the work
  
- ❑ Certified plumbers should be employed by the contractor on the plumbing and sanitary work.
  
- ❑ The standard sectional weights referred to as standard tables in para 5.3.4 (TABLE 5.4) in CPWD specifications for works 2019 vol. 1 to be considered for conversion of length of various sizes of M.S bars and tor steel bars in to weight.
  
- ❑ The entire work is to be completed within the period stipulated i.e. **SIX (06) months** from the 7<sup>th</sup> day of issue of Letter of Intent/Work Order. The period includes monsoon period also. Time shall be the essence of the contract. After the work awarded, the contractors shall furnish detailed time schedules for the approval of the Engineer-in charge which after approval shall form part of the contract and are to be strictly adhere to.
  
- ❑ The maintenance period for the work shall be twelve (12) months and any defects noticed during the period shall have to be rectified by contractor at his cost, failing which the action taken for maintenance Engineer-in charge shall be final over which the contractor will not have any claim.

- ❑ The contractor shall extend all co-operations to the contractors executing works such as electrical, air conditioning etc who might be working at the site and shall permit to use scaffolding etc already put up by him.
- ❑ The Engineer-in charge will have the right to get any item of the work included in this tender or not executed through other agencies. Schedule of probable quantities in respect of the work and specifications are enclosed. The schedules of probable quantities are liable to alterations by emission, deduction or additions at the discretion of the Engineer-in charge.
- ❑ The rates quoted by the tenderer in the schedule shall be inclusive of all taxes and levies. Such rates should provide the break-up of the cost and applicable taxes, levies etc.
- ❑ Samples of all materials to be incorporated in the works shall be submitted to the Engineer-in charge for his approval without claiming any extra cost. Materials not confirming strictly to the samples are liable to be rejected.
- ❑ The employment of any sub-contractors will be subjected to the approval of the Engineer-in-charge. If at any time during the progress of the work the Engineer-in charge determines that any sub-contractor is incompetent or undesirable the contractor shall take steps immediately to cancel such sub-contractor. The contractor shall be entirely responsible for all the work included in the contract whether executed by him or through his sub-contractors. In particular it may be noted that the contractor shall obtain steel doors and windows from a reputed manufacturer and before placing order for these, the contractor shall obtain the concurrence of the department for the agency from whom he proposes to obtain steel doors and windows.
- ❑ The contractor shall prepare a CPM /PERT /BAR chart/ detailed estimate programme within a week's time of issue of Work Order.
- ❑ All materials and articles brought by the contractor to the work site shall have to be declared at the security gate. Similarly no materials shall be taken out from the departmental premises without proper gate pass which will be issued by the Engineer-in charge.
- ❑ Unless otherwise provided in the schedule of quantities the rates tendered by the contractor shall be all inclusive and shall apply to all heights, lifts, leads and depths of the building and nothing extra shall be payable to him on this account.
- ❑ Sample of various materials required for testing shall be provided free of charge by the contractor. Testing charges, if any unless otherwise provided, shall be borne by the department. All other expenditure required to be incurred for taking the samples, conveyance, packing etc. shall be borne by contractor himself. In case of concrete and reinforced concrete work, the contractor shall be required to make arrangement for carrying out compression strength tests at his own cost including preparation of cubes curing etc. complete.

- ❑ For the purpose of recording measurements and preparing running account bills, the abbreviated nomenclature shall be accepted along with the item number.
- ❑ The contractor shall along the tender submit a schedule of machinery to be used on the work in support of his assurance to adhere to the time schedule specified in the proforma given.
- ❑ I /We declare that the work will be carried out as per the specifications in tender document and as per the specifications said above. The items of work not covered in the specifications said above will be carried out as per the specifications in the relevant CPWD specifications, and if not covered in CPWD specifications the work will be carried out as in the relevant IS specifications, and if not covered in the any of the above, the work will be carried out as directed in writing by the Engineer- in charge.
- ❑ I / We declare that the rates quoted by me/us are on the basis of the above.

**Dated: -----**

**Signature of the contractor with stamp**

# **TENDER FORM**

To,

The Director,  
Indian institute of Astrophysics,  
Koramangala,  
Bengaluru - 560034

Dear Sir,

**Sub: Tender for project: “Renovation of Guest rooms and General toilets with a provision of toilet for Divyangjan at Main Lab building CREST campus, Hosakote, Bengaluru Rural Dist”**

With reference to the tender invited by you for the above proposed work, I /we write this after having:

- a). Examined the designs, drawings, detailed specifications to tenders, sample agreement, the general conditions of contract and special conditions of contract annexed there to (here in after called „the contract documents”) relating to construction.
- b). Visited and examined the site of the proposed work and acquired the requisite information relating to or affecting the tender. We are agreed to the decisions of the pre bid meeting by signing and stamping the minutes of the meeting which is enclosed along with this tender.

I/We undersigned hereby offer to construct the proposed work in strict accordance with the contract document for the consideration to be calculated in terms of the priced schedule of quantities.

I/We undertake to complete the whole of the works as per the attached schedule from the date of issue of intimation by you that our tender has been accepted and up on being permitted to enter site. I/We further undertake that on failure, subject to the conditions of contract relating to extension of time, I/We shall be agreed „Liquidated damages” for the period during which the work shall remain incomplete.

I/We hereby deposit with you as earnest money **Rs..... (RUPEES**  
**.....ONLY) [Carrying no interest]**  
and I/We fail to take up the contract when called up on to do so.

Our Bankers are

1.

2.

Place:

Date:

Signature of the tenderer  
Name of the partners of the firm  
Or  
Name of the person having power of attorney to sign the contract



## **SPECIAL CONDITIONS**

### **GENERAL:**

**SPECIAL CONDITIONS OF CONTRACT shall be read in conjunction with GENERAL CONDITIONS OF CONTRACT and both form an integral part of contract. Where the two are at variance, the conditions stipulated in this as SPECIAL CONDITIONS shall supersede relevant GENERAL CONDITIONS.**

### **1. SPECIAL CONDITIONS:**

#### **HELMETS :**

As a measure of safety, persons employed on the site, Engineers and Supervisors shall wear a helmet of approved make at all times when they are at the site. No visitors shall be allowed on work site without wearing helmet.

Contractors shall make arrangements to provide safety helmets to all the persons employed on the site, Engineers and Supervisors at his cost.

Contractors shall display safety and warning signs at strategic locations at the site.

#### **CHILD LABOUR:**

Contractor or his Sub-contractor shall not employ any child labourers on the work site, either permanently or temporarily. It shall be the responsibility of the main Contractor to make sure that no child labour is employed at the site. Contractor shall indemnify the Employer against any consequences statutory or otherwise, that may arise out of employing child labour on the site.

#### **TEMPORARY ELECTRICAL WIRING:**

It shall be the responsibility of the main Contractor to make sure that the temporary wiring for construction activity shall adhere to minimum safety precautions as per Electricity Act. All wires / cables shall be drawn on wooden poles properly fixed and shall be drawn overhead.

### **2. LABOUR SHEDS:**

Labour sheds shall be constructed with non-combustible materials like GI sheets or Asbestos sheets. Contractor will not be permitted to use combustible materials such as palm leaves etc., for the construction of the labour sheds.

### **3. MATERIALS SUPPLY / PROCUREMENT:**

No materials will be supplied by the owner. If any increase on the material procurement cost/ labour, P&M will not be entertained for any kind of escalation till completion of the project.

### **4. BILLING CERTIFICATION & PAYMENT OF BILLS:**

#### **BILLING:**

The contractor shall prepare measured bills after completing the quantum of work as per the standard format and submit the same to the Institute for checking and issue of Certificates for Payment. A proper tax invoice (with breakup of the cost and taxes) shall be submitted and bill shall be settled within 30 days of receipt at IIA. Running account bills shall be prepared and submitted and payment is subject to consideration of the engineer in Charge/IIA.

**PAYMENT OF BILLS:**

The contractor shall be paid by the Employer from time to time based on the certificate from the architect/project in charge for running bill accounts and final bill.

**5. REPAIR OF WORKS DONE BY OTHER AGENCIES:**

The civil contractor shall make up any deficiency in the finishing of the areas damaged by other agencies in a workmanlike manner to achieve uniform finishing of the building at no extra cost.

**6. MATERIAL TESTS:**

The contractor shall provide such assistance, instruments, machines, labour and materials as are normally required for examining, measuring and testing.

The contractor shall install a compression testing machine at site to test concrete cubes and solid blocks.

The contractor shall maintain a record of all the test results in an approved format and periodically submit the same for Architect's/Employer's scrutiny.

**7. PLANT & MACHINERY:**

The contractor is obliged to furnish to the Employer detailed list of equipment, plant, machinery & personnel proposed to be deployed in this project.

**8. CLIENT'S & ARCHITECT'S OFFICES & FACILITIES:**

The contractor shall supply, erect and satisfactorily maintain in good repair until final completion of works, a well lighted temporary site office.

The contractor shall provide at all times for the duration of the contract survey instruments for the exclusive use of consultants as directed by consultants for carrying out of his duties in connection with the contract.

Such instruments which must be approved by the Architect shall include but not limited to the following:

- One theodolite & tripod capable of reading to 20 seconds
- One level with horizontal circle and tripod.
- Two metric leveling staffs not less than 3.5mtr high.
- One 100 metre rustless steel band, one 30 metre rustless steel tape and two 30 metre linen tapes.
- An adequate number of ranging rods drop arrows, wooden setting-out pegs, etc.

The contractor shall be solely responsible for all such instruments and equipment's and shall ensure that they are at all times in good repair and adjustment.

**9. SANITATION & DRAINAGE DURING CONSTRUCTION:**

The contractor shall provide sanitation and drainage facilities on the site as stated subsequently.

The contractor shall strictly control the labour so that the site is not polluted, made dirty or littered with debris, wastes or the likes. Any person found creating mess or litter

or pollution shall be removed from the site immediately at contractor's cost.

The contractor shall provide sanitation facilities at convenient locations on site to preserve the cleanliness of the site. The effluent shall be directed as follows:

- Waste water : Collection and pumping out and disposal off the site in approved manner.
- Sewage : Septic tank provision - sludge to be collected and disposed off at intervals as directed.

The location of the above provisions shall be as marked on the site mobilization scheme drawing.

**10. DISCREPANCIES:**

The contractor shall bring to the notice of the Architect any discrepancies within or between contract drawings and/or the other contract documents prior to preparation of working drawings and commencement of work and shall not proceed with work until the Architect gives clarifications and instructions to proceed.

**11. REPORTS BY CONTRACTOR:**

- 11.1 The contractor shall file daily category-wise labour return. The report shall indicate scheduled requirement against actual strength.
- 11.2 The contractor shall prepare weekly reports of planned and actual progress of work and subsequent week's scheduled work. These will also include material procurement status. These reports shall be submitted to Architect and shall be reviewed during weekly co-ordination meeting.
- 11.3 The contractor shall submit monthly report along with monthly bills.
- 11.4 Further progress charts and schedules shall be prepared by the contractor as directed by the Architect.
- 11.5 The contractor shall submit re-conciliation statement of all the materials supplied by the Client, if any, along with every running & final bill.

**12. FORCE MAJEURE:**

If the work(s) be delayed by:-

- (i) Force majeure, or
- (ii) Abnormally bad weather, or
- (iii) Serious loss or damage by fire, or
- (iv) Civil commotion, local commotion of workmen, strike or lockout, affecting any of the trades employed on the work, or
- (v) Delay on the part of other contractors or tradesmen engaged by Engineer-in-Charge in executing work not forming part of the Contract, or

- (vi) Non-availability of stores, which are the responsibility of Government to supply or
- (vii) Non-availability or break down of tools and Plant to be supplied or supplied by Government or
- (viii) Any other cause which, in the absolute discretion of the Engineer-in-Charge is beyond the Contractor's control.

Then upon the happening of any such event causing delay, the Contractor shall immediately give notice thereof in writing to the authority as indicated in Schedule but shall nevertheless use constantly his best endeavours to prevent or make good the delay and shall do all that may be reasonably required to the satisfaction of the Engineer-in-Charge to proceed with the works.

### **13. PERFORMANCE GUARANTEE:**

To ensure due performance of the contract, performance security or Performance Bank Guarantee (PBG) is to be obtained from the successful bidder awarded the contract. Performance security should be for an amount of three (3) percent of the value of the contract or as per the prevailing notification on the date of work order.

In works contract it is usual to take three percent of contract value Performance Security. Performance security may be furnished in the form of an account payee demand draft, fixed deposit receipt from a commercial bank, bank guarantee issued/ confirmed from any of the commercial bank in India or online payment in an acceptable form, safeguarding the client's interest in all respects.

Performance Security is to be furnished by a specified date generally 21 (twenty-one) days after notification of the award and it should remain valid for a period of 60 (sixty) days beyond the date of completion of all contractual obligations of the contractor, including Defect Liability Period (DLP).

The performance security will be forfeited and credited to the procuring entity's account in the event of a breach of contract by the contractor. It should be refunded to the contractor without interest, after he duly performs and completes all obligations under the contract but not later than 365 days of completion of the Defect Liability Period (DLP). Return of Bid/ Performance Securities should be monitored and delays should be avoided. If feasible, so as to make the process transparent and visible.

### **14. ARBITRATION:**

All disputes or differences which may arise between the IIA and the contractor, with regard to the meaning or interpretation or matter or things done or to be done in pursuance thereof, shall be resolved as per the Indian Arbitration Act 1996 by the Sole Arbitrator. The Director IIA is the sole arbitrator and his decision shall be final and binding on both the parties.

In case any dispute or difference shall arise between the IIA and the contractor either during the progress or after the completion or abandonment of the works as to the construction of this contract or as to any matter or thing of whatsoever nature arising there under or in connection therewith, then such dispute or difference shall be and is hereby referred to the Arbitration of a common Arbitrator, if agreed upon or otherwise to two Arbitrators one to be appointed by each party to the dispute and the Arbitration shall be governed by the Arbitration Act, for the time being in force.

## **15. PLANNING AND DESIGNING IN PURVIEW OF VULNERABILITY ATLAS OF INDIA:**

Vulnerability Atlas of India (VAI) is a comprehensive document which provides existing hazard scenario for the entire country and presents the digitized State/UT-wise hazard, maps with respect to earthquakes, winds and floods for district-wise identification of vulnerable areas. It also includes additional digitized maps for thunderstorms, cyclones and landslides. The main purpose of this Atlas is its use for disaster preparedness and mitigation at policy planning and project formulation stage.

This Atlas is one of its kind single point source for the various stakeholders including policy makers, administrators, municipal commissioners, urban managers, engineers, architects, planners, public etc. to ascertain proneness of any city/location/site to multi-hazard which includes earthquakes, winds, floods, thunderstorms, cyclones and landslides. While project formulation, approvals and implementation of various urban housing, buildings and infrastructures schemes, this Atlas provides necessary information for risk analysis and hazard assessment. The Vulnerability Atlas of India has been prepared by Building Materials and Technology Promotion Council under Ministry of Housing and Urban Affairs, Government of India and available at their website [www.bmtpc.org](http://www.bmtpc.org).

It is mandatory for the bidders to refer Vulnerability Atlas of India for multi-hazard risk assessment and include the relevant hazard proneness specific to project location while planning and designing the project in terms of :

- i) Seismic zone (II to V) for earthquakes
- ii) Wind velocity (Basic Wind Velocity: 55, 50, 47, 44, 39 & 33 m/s)
- iii) Area liable to floods and Probable max. surge height
- iv) Thunderstorms history
- v) Number of cyclonic storms/severe cyclonic storms and max. sustained wind specific to coastal region.
- vi) Landslides incidences with Annual rainfall normal
- vii) District wise Probable Max. Precipitation

## **SPECIAL NOTE TO THE BIDDERS**

1. The bidders are requested to visit the site and to get complete knowledge about the site conditions before quoting the rates. The date of site visit is on 18.07.2022, Tuesday in presence of concerned officers/Engineers of IIA.
2. The availability of materials, transportation of materials etc. to be ascertained before quoting the rate.
3. No labour will be allowed to work/stay beyond working hours and during institute holidays. If need to work/stay beyond working hours on holidays, prior permission from the Engineer in Charge / Scientist in Charge should be obtained in writing.
4. No water and electricity will be supplied by IIA and separate arrangement has to be made by the contractor.
5. Quality and time for completion are the main essence of the contractor and contractor has to keep in mind while quoting the rates.
6. Since the area under renovation is scientific activity area, proper care to be taken to avoid disturbance to the working personnel.
7. All the debris shall be kept in one place as directed by the Engineer in Charge and disposed off outside the campus on working days. Working area / surrounding area shall be kept neat and clean every day after the work is completed.
8. All the materials shall be approved by IIA by providing sample / mock up before executing the complete work. Clarification regarding tender clauses, technical specification, rate analysis etc. will be confirmed by referring to CPWD guidelines, works manual, specifications and analysis of rate which is binding on the contractor. Indian Standards (IS) shall be followed for execution of works. The same will be referred for any clarification during execution of works.
9. The lowest quoted bidder cannot claim as lowest bidder unless the bidder satisfies all the tender conditions, technical qualifications and eligibility with supported documents complete in all respect.
10. **Please find the check list enclosed in the last page of this tender document and comply accordingly. (No document will be considered without check list compliance)**

## **COVID-19 Guidelines for Construction Workers**

- ❖ IIA is committed for protecting the health and safety of construction workers and workplaces during the COVID-19 pandemic. The contractor is hereby informed to adhere the following steps to reduce risk of spread to the corona virus for construction workers:
- ❖ Instruct workers who are sick/ having symptoms to stay away from site.
- ❖ Implement physical distancing practices to maintain at least 2 mts between co-workers/contractors/visitors, including while inside work trailers.
- ❖ Minimize close discussions at site among workers and visitors (including toolbox talks and safety meetings).
- ❖ Provide and have all workers wear face coverings (i.e., cloth face coverings or surgical masks) that have at least two layers of tightly woven breathable fabric, unless their work task requires a respirator. Face coverings should be provided at no cost to workers.
- ❖ Continue to use other normal control measures, including personal protective equipment, necessary to protect workers from other job hazards associated with construction activities.
- ❖ Provide and ensure workers use the supplies necessary for good hygiene practices. If workers do not have immediate access to soap and water, use alcohol-based hand sanitizers that contain at least 60 percent ethanol or 70% isopropanol.
- ❖ Do not allow workers to share tools and equipment. If sharing cannot be eliminated, clean and disinfect between each use.
- ❖ Clean and disinfect portable jobsite toilets and fill hand sanitizer dispensers regularly.
- ❖ IIA will take safety measures in view of COVID-19 at main gate by way of thermal scanning and hand sanitization for which all workers should cooperate.

# LIST OF APPROVED MATERIALS

## CIVIL

Sl. No	Material	Make
1	Steel	SAIL – TMT, VIZAG STEEL
2	Cement	ACC / Birla / L & T
3	Acrylic Exterior Emulsion	Asian Paints / Nippon paints / Berger paints
4	Plastic Emulsion Paint	Asian Paints / Nippon paints / Berger paints
5	Enamel Paint	Asian Paints / Nippon paints / Berger paints
6	Aluminium	Tata / Jindal or equivalent
7	Glass	Saint Gobain, Modi
8	Flush Door	Greenply / Century door / Kuttys Bond Wood
9	M.S. sections	Zindal / Tata / Vizag steel
10	Veneer / laminate /ply	Century / Greenlam / merino
11	Waterproofing	Fosroc / IS approved or equivalent
12	Vitrified Tiles	Kajariya / Nitco / Rak
13	Ceramic tiles	Kajariya / Nitco / Rak
14	G I sheet	Tata / JSW / IS approved or equivalent
15	Commercial Ply	Commercial Boards Century, Green, Duro, Merino
16	Laminates	Century, Greenlam, Merino or equivalent
17	3 Sanitary Fixtures (WC, Basin etc.)	Hindware, Cera
18	Handle & Locks	Godrej/ Plaza/ Harrison
19	12 C PVC Pipe	Prince, Finolex, or equivalent
20	GI Pipe	Jindal, Tata,



**WATER SUPPLY AND SANITARY WORKS**

<b>Sl.No.</b>	<b>Material</b>	<b>Make</b>
1	PVC	Ashirvad / Kisan / Supreme
2	CPVC	Astral / Ashirvad / Supreme / Prince
3	C.P. Fittings	Jaguar / Hindware / approved equivalent
4	Ceramic fittings	Hindware / Jaguar / approved equivalent
5	SFRC manhole frame and Covers	Southern Concrete Industries/approved equivalent
6	Kitchen sink	Hindware / Cera / Nirali / Approved Equivalent
7	SS Grating & MH frame & cover	NECO / Approved equivalent

1. The colour design and sample of all item and makes are to be approved by Client/IIA.
2. Work will be carried out as per CPWD specification and I. S. code.

# **BILL OF QUANTITIES**

**Bill of quantities for the work of “Renovation of Guest rooms and General toilets with a provision of toilet for Divyangjan at Main Lab building CREST campus, I.I.A, Hosakote, Bengaluru Rural Dist.”**

**(NOTE: Rates shall be quoted after reading the complete Specifications and understanding site conditions)**

Sl. No	Description	Quantity	Unit	Rate (Rs.)		Amount (Rs.)
				In figures	In Words	
1	Demolishing cement concrete manually/ by mechanical means including disposal of material within 50 metres lead as per direction of Engineer - in - charge.					
1.1	Nominal concrete 1:3:6 or richer mix (i/c equivalent design mix)	12.00	cum			
2	Demolishing brick work manually/ by mechanical means including stacking of serviceable material and disposal of unserviceable material within 50 metres lead as per direction of Engineer-in-charge.					
2.1	In cement mortar	4.00	cum			
3	Dismantling doors, windows and clerestory windows, storage unit below the wash basin (steel or wood) shutter including chowkhats, architrave, holdfasts etc. complete and stacking within 50 metres lead :					
3.1	Of area beyond 3 sq. metres	10.00	each			

Sl. No	Description	Quantity	Unit	Rate (Rs.)		Amount (Rs.)
				In figures	In Words	
4	Dismantling G.I. pipes (external work) including excavation and refilling trenches after taking out the pipes, manually/ by mechanical means including stacking of pipes within 50 metres lead as per direction of Engineer-in-charge :					
4.1	15 mm to 40 mm nominal bore	75.00	metre			
5	Dismantling tile work in floors, walls and roofs laid in cement mortar including stacking material within 50 metres lead.					
5.1	For thickness of tiles above 25 mm and up to 40 mm	120.00	sqm			
6	Dismantling of water closet (Both indian and western type) with flushing cistern, urinals and counter type wash basins (Including Granite counter) of all types (C.I./PVC/Vitrious China) including stacking of useful materials near the site and disposal of unserviceable materials within 50 metres lead.	50.00	each			
7	Dismantling old plaster or skirting raking out joints and cleaning the surface for plaster including disposal of rubbish to the dumping ground within 50 metres lead.	200.00	sqm			

Sl. No	Description	Quantity	Unit	Rate (Rs.)		Amount (Rs.)
				In figures	In Words	
8	Disposal of building rubbish / malba / similar unserviceable, dismantled or waste materials by mechanical means, including loading, transporting, unloading to approved municipal dumping ground or as approved by Engineer-in-charge, beyond 50 m initial lead, for all leads including all lifts involved.(diposed within the campus as instructed by IIA)	30.00	cum			
9	Providing and laying in position cement concrete of specified grade including the cost of centering and shuttering - All work up to plinth level :					
9.1	1:1½:3 (1 Cement: 1½ coarse sand (zone-III) derived from natural sources : 3 graded stone aggregate 20 mm nominal size derived from natural sources)	15.00	cum			
10	Providing and laying in position specified grade of reinforced cement concrete, including the cost of centering, shuttering, finishing and reinforcement - All work up to plinth level :					
10.1	1:1.5:3 (1 cement : 1.5 coarse sand(zone-III) incuding manufactured	15.00	cum			
11	Steel reinforcement for R.C.C. work including straightening, cutting, bending, placing in position and binding all complete upto plinth level.					
11.1	Thermo-Mechanically Treated bars of grade Fe-500D or more.	250.00	kg			

Sl. No	Description	Quantity	Unit	Rate (Rs.)		Amount (Rs.)
				In figures	In Words	
12	Brick work with common burnt clay F.P.S. (non modular) bricks of class designation 7.5 in superstructure above plinth level up to floor V level in all shapes and sizes in :					
12.1	Cement mortar 1:4 (1 cement : 4 coarse sand)	20.00	cum			
13	Half brick masonry with common burnt clay F.P.S. (non modular) bricks of class designation 7.5 in superstructure above plinth level up to floor V level.					
13.1	Cement mortar 1:3 (1 cement :3 coarse sand)	35.00	Sqm			
14	Centering and shuttering including strutting, propping etc. and removal of form work for :					
14.1	Foundations, footings, bases for columns	65.00	Sqm			

Sl. No	Description	Quantity	Unit	Rate (Rs.)		Amount (Rs.)
				In figures	In Words	
15	Providing and laying ceramic floor tiles in different sizes (thickness to be specified by the manufacturer) with water absorption less than 0.08% and conforming to IS:15622, of approved brand & manufacturer, in all colours and shade, laid on 20 mm thick cement mortar 1:4 (1 cement: 4 coarse sand) jointing with grey cement slurry @3.3 kg/sqm including grouting the joints with white cement and matching pigments etc. The tiles must be cut with the zero chipping diamond cutter only . Laying of tiles will be done with the notch trowel, plier, wedge, clips of required thickness, leveling system and rubber mallet for placing the tiles gently and easily. Basic rate: 70 Rs/Sft					
15.1	Antiskid tiles					
15.2	Size of Tile 600 x 600/ 300X 300 mm	200.00	sqm			
16	Providing and fixing Ist quality ceramic glazed wall tiles conforming to IS: 15622 (thickness to be specified by the manufacturer), of approved make, in all colours, shades except burgundy, bottle green, black of any size as approved by Engineer-in-Charge, in skirting, risers of steps and dados, over 12 mm thick bed of cement mortar 1:3 (1 cement : 3 coarse sand) and jointing with grey cement slurry @ 3.3kg per sqm, including pointing in white cement mixed with pigment of matching shade complete. Basic rate: 75Rs/Sft	250.00	sqm			

Sl. No	Description	Quantity	Unit	Rate (Rs.)		Amount (Rs.)
				In figures	In Words	
17	<b>PLASTERING INTERNAL SURFACES:</b> Plastering 20mm thick with cement mortar specified below, finished smooth with lime neeru, including scaffolding, curing, etc; complete for INTERNAL SURFACES of stone masonry/brick masonry walls sills, jambs, etc; complete all as per specifications UPTO FLOOR LEVEL, mix specified is for cement: fine sand. <b>NOTE:</b> CM 1:3 OR 1:4 is generally applicable for ceilings and RCC surfaces unless otherwise specified.					
17.1	with CM 1:4	180.00	sqm			
18	<b>CEMENT PLASTER (IN COARSE SAND):</b> 12 mm cement plaster of mix : 1:4 (1 cement: 4 coarse sand)	200.00	sqm			
19	Providing and applying plaster of paris putty of 2 mm thickness over plastered surface to prepare the surface even and smooth complete. Rate shall be quoted after reading the complete Specifications and understanding site conditions.	450.00	sqm			
20	Wall painting with premium emulsion paint of approved brand and manufacture to give an even shade including primer coat:					
20.1	One or more coats on old work	750.00	Sqm			
21	Painting with synthetic enamel paint of approved brand and manufacture of required colour to give an even shade :					



Sl. No	Description	Quantity	Unit	Rate (Rs.)		Amount (Rs.)
				In figures	In Words	
21.1	One or more coats on old work	150.00	sqm			
22	Finishing walls with Acrylic Smooth exterior paint of required shade :					
22.1	Old work (Two or more coat applied @ 1.67 ltr/ 10 sqm) on existing cement paint surface	50.00	sqm			
23	PU Melamine polishing on wood work (one or more coat). Including necessary works.	150.00	sqm			
24	Providing and fixing table top/counter type wash basin with C.I. brackets, 15 mm C.P. brass pillar taps, bottle trap/ waste coupling with waste pipe, including painting of fittings and brackets, cutting and making good the walls wherever require: basic price: Rs. 3800/piece					
24.1	White Vitreous table top Wash basin size 630x450 mm with a pair of 15 mm C.P. brass pillar taps	18.00	each			
25	Providing and fixing 18 mm thick gang saw cut, mirror polished, premoulded and prepolished, machine cut for kitchen platforms, counter type/table top wash basins, vanity counters, window sills, facias and similar locations of required size, approved shade, colour and texture laid over 20 mm thick base cement mortar 1:4 (1 cement : 4 coarse sand), joints treated with white cement, mixed with matching pigment, epoxy touch ups, including rubbing, curing, moulding and polishing to edges to give high gloss finish with necessary works. complete at all levels.basic price:Rs 260/sft					

Sl. No	Description	Quantity	Unit	Rate (Rs.)		Amount (Rs.)
				In figures	In Words	
25.1	Granite stone slab colour black, Cherry/Ruby red					
25.2	Area of slab over 0.50	45.00	sqm			
26	Providing and fixing white vitreous china flat back half stall urinal of size 580x380x350 mm with white PVC automatic flushing cistern, with fittings, standard size C.P. brass flush pipe, spreaders with unions and clamps (all in C.P. brass) with waste fitting as per IS : 2556, C.I. trap with outlet grating and other couplings in C.P. brass, including painting of fittings and cutting and making good the walls and floors wherever required : basic price: Rs. 10,000/each					
26.1	Single half stall urinal with 5 litre P.V.C. automatic flushing cistern	10.00	each			
27	Providing and fixing white vitreous china extended wall/floor mounting water closet/ floor mount of size 780x370x690 mm of approved shape including providing & fixing white vitreous china cistern with dual flush fitting, of flushing capacity 3 litre/ 6 litre (adjustable to 4 litre/ 8 litres), including seat cover, and cistern fittings, nuts, bolts and gasket etc complete.basic price:Rs.10,000/each	13.00	each			
28	Providing and fixing C.P. brass stop cock (concealed) of standard design and of approved make conforming to IS:8931. Make: Jaguar/Hindware. Base Price: 450 Rs/Each					
28.1	15 mm nominal bore	65.00	each			

Sl. No	Description	Quantity	Unit	Rate (Rs.)		Amount (Rs.)
				In figures	In Words	
29	Providing and fixing toilet paper holder :					
29.1	C.P. brass	4.00	each			
30	Providing and fixing of Hnad dryer in general toilets at Main lab building, CREST campus, Hosakote. Make: Prestige Two Waves Automatic Hand Dryer Machine. Base Price: 4000 Rs/Each	6.00	each			
31	Providing and fixing C.P. brass shower rose/head with 15 or 20 mm inlet : Make: Jaguar/Hindware. Base Price: 1400 Rs/Each					
31.1	100 mm diameter	12.00	each			
32	Providing and fixing ball valve (brass) of approved quality, High or low pressure, with plastic floats complete :					
32.1	15 mm nominal bore	1.00	each			
33	Providing and fixing PTMT liquid soap container 109 mm wide, 125 mm high and 112 mm distance from wall of standard shape with bracket of the same materials with snap fittings of approved quality and colour, weighing not less than 105 gms. Make: Jaguar/Hindware. Base Price: 600 Rs/Each	24.00	each			

Sl. No	Description	Quantity	Unit	Rate (Rs.)		Amount (Rs.)
				In figures	In Words	
34	Providing and fixing beveled edge mirror of superior glass of existing size (1.5M X 0.8M) with approved quality, complete with 6 mm thick hard board ground fixed to wooden cleats with C.P. brass screws and washers complete.	6.00	each			
35	Providing and fixing beveled edge mirror of superior glass of existing size (3.5M X 0.8M) with approved quality, complete with 6 mm thick hard board ground fixed to wooden cleats with C.P. brass screws and washers complete.	4.00	each			
36	Providing wood work in frames of doors, windows, clerestory windows and other frames, wrought framed and fixed in position with hold fast lugs or with dash fasteners of required dia & length (hold fast lugs or dash fastener shall be paid for separately).					
36.1	Second class teak wood	0.70	cum			
37	Providing and fixing ISI marked flush door shutters conforming to IS :2202 (Part I) decorative type, core of block board construction with frame of 1st class hard wood and well matched teak 3 ply veneering with vertical grains or cross bands and face veneers on both faces of shutters.					
37.1	35 mm thick including ISI marked Stainless Steel butt hinges, handles, locks, with necessary screws etc, complete the work as per Engineer In-charge.	30.00	sqm			

Sl. No	Description	Quantity	Unit	Rate (Rs.)		Amount (Rs.)
				In figures	In Words	
38	Providing and fixing Chlorinated Polyvinyl Chloride (CPVC) pipes, having thermal stability for hot & cold water supply, including all CPVC plain & brass threaded fittings, i/c fixing the pipe with clamps at 1.00 m spacing. This includes jointing of pipes & fittings with one step CPVC solvent cement and the cost of cutting chases and making good the same including testing of joints complete as per direction of Engineer in Charge. <b>Concealed work</b> , including cutting chases and making good the walls etc.					
38.1	20 mm nominal dia Pipes	50.00	metre			
38.2	25 mm nominal outer dia Pipes	50.00	metre			
39	Providing and fixing CP two in one tap of approved quality :					
	15 mm nominal bore. Two in one bib cock	24.00	each			
40	Providing and fixing Health faucet. (Make: Jaguar)	25.00	each			
41	Providing and fixing mortise handle lock with necessary works. Make: Godrej/ Dorma	20.00	each			
42	Providing and fixing door handle with necessary works. Make: Godrej/ Dorma	20.00	each			
43	Providing and fixing Nahani trap with CP/SS gratings with necessary cement works.	62.00	each			

Sl. No	Description	Quantity	Unit	Rate (Rs.)		Amount (Rs.)
				In figures	In Words	
44	Providing and fixing C.P. brass bib cock of approved quality conforming to IS:8931 :Make: Jaguar/Hindware. Base Price: 450 Rs/Each					
44.1	15 mm nominal bore	12.00	each			
45	Providing and fixing PTMT Bottle Trap for Wash basin and sink.					
45.1	Bottle trap 31mm single piece moulded with height of 270 mm, effective length of tail pipe 260 mm from the centre of the waste coupling, 77 mm breadth with 25 mm minimum water seal, weighing not less than 260 gms Make: Jaguar/Hindware. Base Price: 850 Rs/Each	18.00	each			
46	Providing and fixing C.P. brass stop cock/angle of standard design and of approved make conforming to IS:8931.Make: Jaguar/Hindware. Base Price: 450 Rs/Each					
46.1	15 mm nominal bore	70.00	each			
47	Providing and fixing PTMT/SS towel rail complete with brackets fixed to wooden cleats with CP brass screws with concealed fittings arrangement of approved quality and colour.Make: Jaguar/Hindware. Base Price: 800 Rs/Each					
47.1	600 mm long towel rail with total length of 645 mm, width 78 mm and effective height of 88 mm, weighing not less than 190 gms.	15.00	each			

Sl. No	Description	Quantity	Unit	Rate (Rs.)		Amount (Rs.)
				In figures	In Words	
48	Providing and fixing steel braided hot & cold water connection pipes for geyser with necessary fixuters.	25.00	each			
49	Providing and fixing aluminium die cast body tubular type universal hydraulic door closer (having brand logo with ISI, IS : 3564, embossed on the body, door weight upto 35 kg and door width upto 700 mm), with necessary accessories and screws etc. complete. Make: Godrej/Dorma Basic rate: 1200Rs/each	10.00	each			
50	Providing, laying and jointing unplasticized PVC pipes and specials of working pressure as mentioned below conforming to IS:4985 including cost of necessary jointing materials, labour for excavation of trenches, testing, refilling etc., complete all as per specifications.					
50.1	6 kg/sqcm and 110mm OD	25.00	meter			
51	Providing & fixing glass panes with putty and glazing clips in steel doors, windows, clerestory windows, all complete with :					
51.1	5.5 mm thick glass panes	35.00	sqm			

Sl. No	Description	Quantity	Unit	Rate (Rs.)		Amount (Rs.)
				In figures	In Words	
52	Providing and applying fibre reinforced elastomeric liquid water proofing membrane with resilient acrylic polymers having Sun Reflectivity Index (SRI) of 105 on top of concrete roof in three coats @10.76 litre/ 10 sqm. One coat of self-priming of elastomeric waterproofing liquid (dilution with water in the ratio of 3:1) and two coats of undiluted elastomeric waterproofing liquid (dry film thickness of complete application/system not less than 500 microns). The operation shall be carried out after scrapping and properly cleaning the surface to remove loose particles with wire brushes, complete in all respect as per the direction of Engineer-in-Charge.	480.00	Sqm			
53	Treating the Construction Joints : Chase opening the Construction Joints by providing “ V ” groove, removing the dust and clean the designated area following by providing chemical injection treatment in the form of pressure grouting to the cold joint by injecting cement slurry mixed with grout admixture Cebex 100 @ 225 gms.per bag of cement, in the required consistency through the pre fixed PVC nozzles in the 18 mm dia holes, fixing of PVC nozzles with Renderoc Plug and final cutting the projected nozzles and sealing off the PVC nozzles after the injection operation is over with Renderoc plug, nonshrink rapid setting mortar compound, finishing, curing etc. as per manufacturers specification and as directed	25.00	meter			



Sl. No	Description	Quantity	Unit	Rate (Rs.)		Amount (Rs.)
				In figures	In Words	
54	Deep cleaning of toilets with necessary liquids/Acid's etc, complete the work as per directions of Engineer-Incharge.	800.00	Sqm			
55	SS name plates 3mm thick of size 12" X 8" with etching of approved design with necessary fixtures etc., complete the work as per directions of Engineer In-Charge.	6.00	Each			
56	Providing & fixing SS mesh with wooden frames steel doors, windows, clerestory windows, all complete with :	30.00	Sqm			
57	Providing and laying water proofing treatment in sunken portion of WCs, bathroom etc., by applying cement slurry mixed with water proofing cement compound consisting of applying : (a) First layer of slurry of cement @ 0.488 kg/sqm mixed with water proofing cement compound @ 0.253 kg/ sqm. This layer will be allowed to air cure for 4 hours. (b) Second layer of slurry of cement @ 0.242 kg/sqm mixed with water proofing cement compound @ 0.126 kg/sqm. This layer will be allowed to air cure for 4 hours followed with water curing for 48 hours. The rate includes preparation of surface, treatment and sealing of all joints, corners, junctions of pipes and masonry with polymer mixed slurry.	35.00	sqm			

Sl. No	Description	Quantity	Unit	Rate (Rs.)		Amount (Rs.)
				In figures	In Words	
58	Providing & fixing UV stabilised fiberglass reinforced acraylic/plastic sheet roofing up to any pitch, including fixing with polymer coated 'J' or 'L' hooks, bolts & nuts 8mm dia. G.I plain/bitumen washers complete but excluding the cost of purlins, rafters, trusses etc. The sheets shall be manufactured out of 2400 TEX panel rovigs incorporating minimum 0.3% ultra-violet stabiliser in resin system under approximately 2400 psi and hot cured. They shall be of uniform pigmentation and thickness without air pockets and shall conform to IS 10192 and IS 12866.The sheets shall be opaque or translucent, clear or pigmented, textured or smooth as specified. Basic price: 850/sqm					
58.1	4 mm thick flat	40.00	sqm			
59	Providing and fixing in position 450 mm deep storage cabinet as directed made out of approved quality 19 mm thick MR grade borer & termite resistant block board. Shutter shall be of 19 mm thick block board with all hardware like 75 mm X 18 mm X 18 mm stainless steel bearing hinges, magnetic catchers, stainless steel handles, locks etc. complete as per sample approved. All internal surfaces of the cabinet including shutters and shelves to be finished with 0.8 mm thick white laminate of approved make and shade as per design. Rate to include providing 8mm thick BWPply,providing and TW lipping to exposed edges of Block board, polishing/painting etc. complete	8.00	sqm			

Sl. No	Description	Quantity	Unit	Rate (Rs.)		Amount (Rs.)
				In figures	In Words	
60	Supply and install wall mounted Stainless steel grab bars of 600mm long grab bar including cutting & making good the walls. Make: Jaguar/Hindware. Base Price: 2500 Rs/Each	4.00	each			
61	Supplying, fitting and fixing Pilar cock Make: Jaguar/Hindware. Base Price: 1800 Rs/Each	18.00	each			
62	Supplying, fitting and fixing Urinal valve auto closing system with built - in - control cock & wall flange. Make: Jaguar/Hindware. Base Price: 600 Rs/Each	10.00	each			
63	Providing and fixing PTMT towel ring trapezoidal shape 215 mm long, 200 mm wide with minimum distances of 37 mm from wall face with concealed fittings arrangement of approved quality and colour, weighing not less than 88 gms. Base Price: 650 Rs/Each	18.00	each			
64	Supply and install wall mounted Stainless steel flip up bar U-shaped including cutting & making good the walls. Make: Jaguar/Hindware. Base Price: 8000 Rs/Each	2.00	each			

Sl. No	Description	Quantity	Unit	Rate (Rs.)		Amount (Rs.)
				In figures	In Words	
65	Providing and fixing white vitreous china pedestal type water closet (European type W.C. pan) with seat and lid for <b>DIVYANJN</b> , 10 litre low level white P.V.C. flushing cistern, including flush pipe, with manually controlled device (handle lever), conforming to IS : 7231, with all fittings and fixtures complete, including cutting and making good the walls and wherever required : W.C. pan with ISI marked white solid plastic seat and lid Make: Jaguar/Hindware. Base Price: 12,000Rs/Each	1.00	each			
66	Providing & Laying CINDER FILLING in Sunk slab including compacting manually with rammer and finishing true line & level at all floor level etc. complete as directed by E.I.C.	8.00	cum			
67	Providing, fabricating & fixing in position S.S. 304 grade pipe railing for staircase consisting of 18 gauge 50 mm dia.S.S.pipe as top rail,18 gauge 40 mm dia S.S. pipe asverticals, 18 gauge 25 mm dia as secondary rails, including fixing the verticals to the staircase pardi by means of base plate with socket & anchor fasteners,grinding the welded portion smooth,buffering, protecting the railing members by means of wrappers during construction etc. complete as directed by the Engineer in charge.	60.00	kg			

Sl. No	Description	Quantity	Unit	Rate (Rs.)		Amount (Rs.)
				In figures	In Words	
68	Providing and fixing panelled or panelled and glazed shutters to be made of 12 mm thick float glass with teak wood top, bottom rail and styles of section required size(finished size) including Teak wood beadingfor fixing glass. All teak wood to be finished with melamine polish. The float glass to be etched as per approved design including etching color windows and clerestory windows, fixing with butt hinges of required size with necessary screws, including panelling , The rate should include necessary hardware's fixtures with heavy duly floor spring with stainless steel cover plate and one pivot at top, long decorative brass handles foe each shutter. The teak wood surface will be melamine polished to the satisfaction of Bank Engineer. all complete as per direction of Engineer-in-charge.					
68.1	Second class teak wood					
68.2	35 mm thick shutters	12.00	sqm			
						Sub Total (Rs.) (A)
						GST..... % (Rs.)(B)
						Grand Total (A+B)=C

**Grand Total amount in words.....**

.....

Date:

Place:

Signature of the contractor with seal

## **CHECK LIST**

**ALL THE BIDDERS ARE REQUESTED TO COMPLETE THE CHECK LIST WITH NECESSARY DOCUMENTS AND COMPLY ACCORDINGLY**

Sl. No.	Document to be furnished	YES/NO	REMARKS
1	<b><u>COVER 1 (TECHNICAL BID)</u></b>		
a	Complete tender document duly signed by contractor / authorized representative. Power of Attorney to be attached in case of partnership firm) (Published in IIA website)		
b	Tender document fee (Non Refundable)		
c	EMD		
d	Valid class I Contractor License issued by PWD / CPWD etc.		
e	PAN Details		
f	GST Details with latest 3 GST paid receipts		
g	Work completion certificates indicating name of the work, work order details, executed amount, date of completion, etc for each work issued by competent authority as per tender eligibility criteria		
h	Financial Documents like turnover certificate, IT returns for last 3 Financial Years, assessment order issued by Income Tax dept.		
2	<b><u>COVER 2 (FINANCIAL BID)</u></b>		
a	Bill of quantities (signed by contractor / authorized)		
3	<b><u>COVER 3 ( BOTH COVER 1 &amp; 2)</u></b>		
a	Note: Please mention the name of the work, tender number, contractor address etc. on cover / envelop (cover 3)		

Signature of the Contractor with Stamp

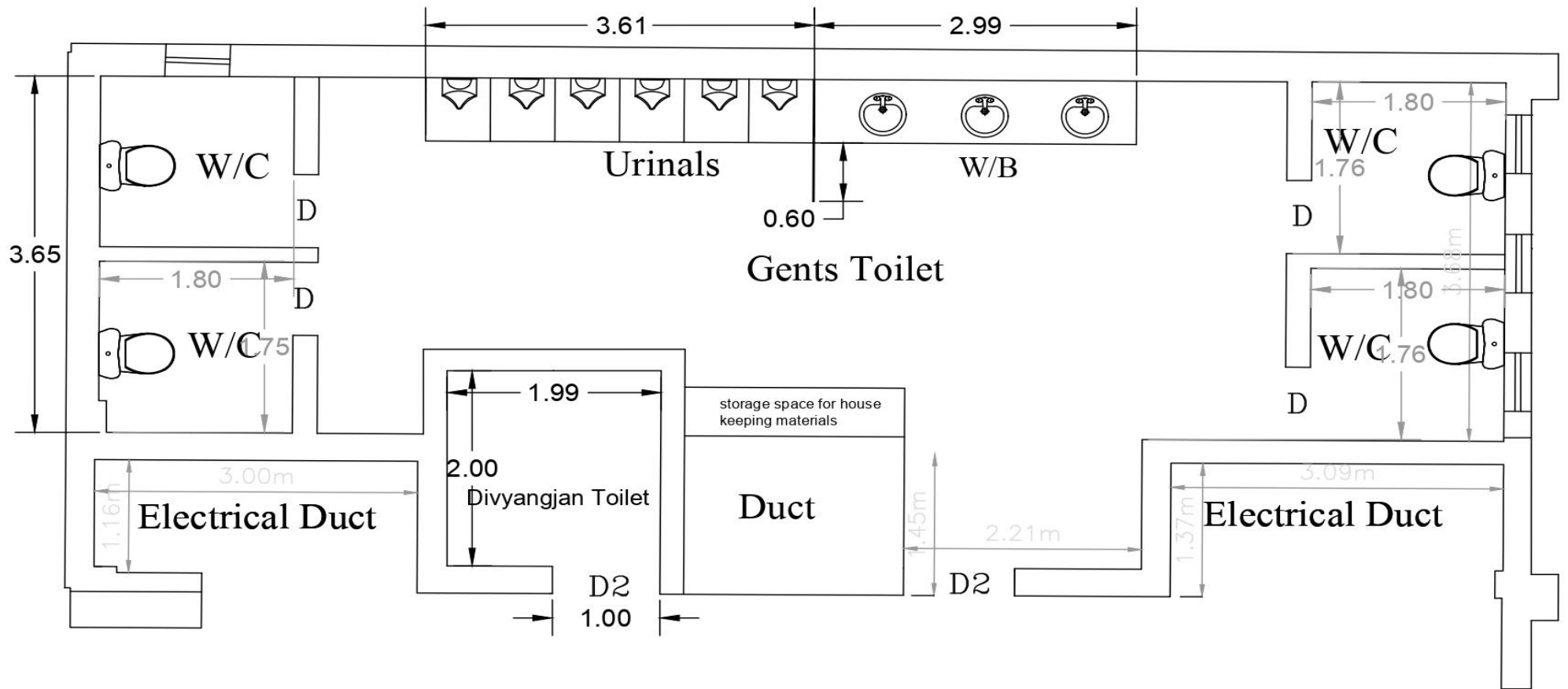

PROPOSED DIVYANGJAN TOILET PLAN AT MAIN LAB BUILDING CREST CAMPUS, HOSAKOTE.